

Article no.: 348145

Surface mounted ceiling lamp, Altai 25W, white, 220-240V AC/50-60Hz, warm white + neutral white + coldwhite

**Technical Data****General Characteristics**

Material	plastic
Colour	white
Optics	
included in delivery	2x screw 2x dowel mounting clamp

Electrical Characteristics

Power / power consumption	/ 25,00 W
Input voltage	220-240V AC/50-60Hz
Input current	
Base (standard designation)	
Number of bases	
Power supply unit	incl. LED-power supply unit
Electronically reversible	not dimmable
Connection possibility	clamp
Protection class I, II, III	II

Light Technical Data

Bulb	LED-module changeable
Colour Designation	warm white + neutral white + coldwhite
Colour temperature	3000/4000/6000 K
Luminous flux	2715 lm
Beam angle	120°
LED type	SMD
LED quantity	
Spectral power distribution	499-583 nm



Article no.: 348145

Surface mounted ceiling lamp, Altas 25W, white, 220-240V AC/50-60Hz, warm white + neutral white + coldwhite

Light Direction

Rotating and tilting range	fixed
Angle of inclination	
Radiation direction	
Reflector / lense	

Dimensions & Weight

Length	0,00
Width	0,00
Height	48,00
Diameter	330,00
Suspensions from ceiling	0,00
Product Weight	962 g

Base dimensions

Length	0,00
Width	0,00
Height	0,00
Diameter	0,00

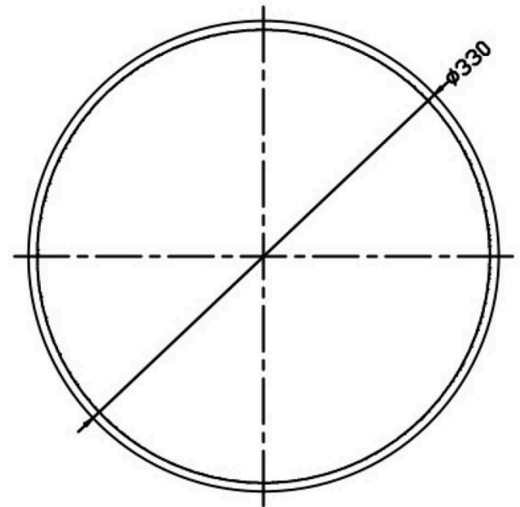

Article no.: 348145

Surface mounted ceiling lamp, Altas 25W, white, 220-240V AC/50-60Hz, warm white + neutral white + coldwhite

Absolute maximum ratings

The LED will get damaged and the lifetime will decrease when you overrun absolute maximum ratings.

Working temperature	-40°C - +50°C
Storage temperature	-10°C - +60°C
IP - Code	IP54

General product data

Environmental Characteristics

Energy label	
Energy consumption	25 kWh/1000h

Lifespan

Lamp life time	50000 h
Luminous flux (end of lifetime)	0,70
Number of switching cycles	75000

IP54 Protection against penetration of dust. (dust protected) Protection against penetration of splashing water.



Lightings of Protection Class II in which the protection against electric shock is not based solely on the insulation, but additional safety precautions such as additional or reinforced insulation are provided. There are no provisions for the connection of an equipment grounding conductor exists, yet underlying the protection of the facility conditions.



Because of the complex manufacturing process of the LED the above shown data are just a statistical size, which is not forced to be the realistic data of every LED.